

# DEVELOPING OF COMMUNITY DESIGN CENTER COLLABORATED BETWEEN UNIVERSITY AND CITIZENS CASE STUDY ON TSUKISHIMA NAGAYA SCHOOL

Member	○ Chenporn Lapcharoen
Same	Jia Yiyang
Same	Moriya Kana
Same	Shimura Hideaki

Community Design    Tsukishima    Center of Community  
Nagaya School        Machizukuri    University

## 1. Introduction

### 1-1. Background and Purpose

Community design (Machizukuri) is definitely spreading activities of universities and citizens collaborating more frequently. There are many occasions when we utilize vacant facilities, establish center of community development, and develop activities. In 2013, the COC (Center of Community) project was supported by the Ministry of Education, Culture, Sports, Science and Technology started, and cooperated between universities and citizens is increasing more and more. However, there are few analytical reports on how to develop town by university and citizen in cooperation. By the way, Shibaura Institute of Technology (SIT) was adopted as a COC project, opened the Tsukishima Nagaya School in Tsukishima, Chuo-Ward, Tokyo, and college students and citizens were doing community development activities. Tsukishima Nagaya School as a case, presented the development and results of community development activities in which universities and citizens were in cooperation.

### 1-2. Method

Tsukishima Nagaya School's activities have been set up for three years from January 2014 to December 2016. First, the outline of Tsukishima Nagaya School will be explained following by the outline of the activities of three years, the main result of activities and the outline of citizen members. Finally, we clarify the development of citizen members and the opportunities for town development activities.

## 2. Tsukishima Nagaya School

### 2-1. Tsukishima

It was a reclaimed land located in the Tokyo Bay Area and completed in 1892. There were many factories, warehouses, and rowhouse workers in recent year redevelopment has been progressing and many apartment towers. There are still many alleys and row houses, and downtown living culture also

remaining. It is also known as the city of Monjayaki.

### 2-2 Tsukishima Nagaya School

Plan view of Nagaya School, outside and inside are shown in Figure.1 It is a building which renovated two houses built in 1926. It is facing the street of 5.4 m and there is an alley a side of a share house. The first floor is the Nagaya School and the second floor is the residence. Nagaya School has an area of 9 tatami size where students and citizens gathering together.

It was established in October 2013 after SIT was adopted as COC project of Ministry of Education, Culture, Sports, Science and Technology. Most activities began in 2014. SIT Regional Design Laboratory manages and opens a website spread the information. There are 15 citizen members of Nagaya School as of December 2016.

## 3. Three year activities

### 3-1. Outline of activities

Activity for three years is shown in Figure 2. At the beginning of 2014, Nagaya School focused on university laboratory activities such as presenting seminal results to citizens. In May 2014, Chuo Ward local college was held at Nagaya School. Then, citizen members of Nagaya School began to come together, basically gathering once a month. Ten people were originally citizen members. The number of

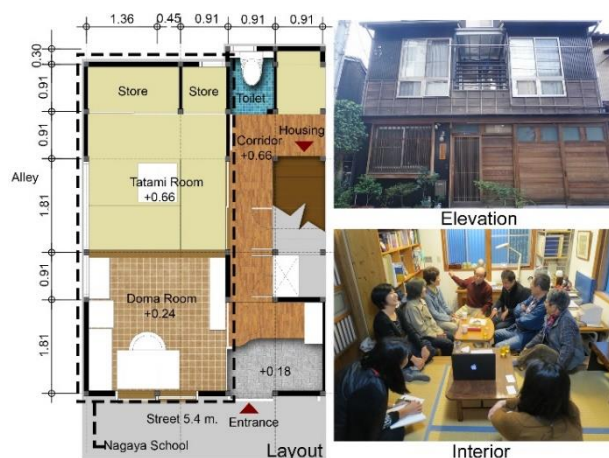

Figure1 Layout, Elevation and Interior of Nagaya School

activities has increased to 11 times in 2014, 15 times in 2015, and 20 times in 2106. Total was three years, with 14 members, 19 SIT students, 147 people visiting, 180 people in total at the Nagaya School.

### 3-2. Main achievements

In October 2015, Tsukishima alley map English version was created by collaboration between students and citizen members (Figure 3). In October 2016, we also created a Tsukishima town walk guide book in collaboration with students and citizen members (Figure 3). As a result of such activities, from 2015 it has come to receive overseas university researchers and students' visits with exchanges.

### 3-3. Citizen Members

Most citizen members living in Tsukishima chair of community association, volunteer town guide, former magazine editor, Chuo-ku media reporter, translator, canoe

club member, former theater member, architect, music school president, regional newspaper editor, professor, web Designers and others.

### 4. Developing of activities

The categories of activities were shown in Figure.4 In 2014, there were a lot of usage in university lessons, lectures, and chat by citizen members. After 2015, concrete projects such as alley map in English version and guide book creation has increased. Since 2015, as the English version of the alley map was completed, exchange increased due to overseas students visits. In 2016, the creation of a guidebook triggered the voluntary activities of the English group of citizen members. Projects through collaboration between students and citizen members triggered activities.

### 5. Summary

The case study of Tsukishima Nagaya School, we showed the developing of Machizukuri activities collaboration between university and citizens. The citizen members created by Chuo Ward local college triggered activities of the Nagaya School. Creation of alley maps and guide books the project of the student and the citizen member, triggered, the voluntary activities of citizen members.

### Reference

-Tsukishima Nagaya School 2017.March.25, <http://www.tsukishima.arc.shibaura-it.ac.jp/>

-Ministry of Education, Culture, Sports, Science and Technology Japan 2017.March.26,

[http://www.mext.go.jp/a\\_menu/koutou/kaikaku/coc/](http://www.mext.go.jp/a_menu/koutou/kaikaku/coc/)

Year	M/D	Category	Activity	Participants	
2014	1/11	Lesson	New year party and seminar	16	Ten citizen members
	1/27	Lesson	Seminar and presentation	12	
	5/12	Lesson	Lesson town develop	29	
	5/24	Lecture	Class	24	New member A
	5/31	Lecture	Walking inTsukishima(Chuo Ward community helped)	24	
	6/15	Chat	Local magazine	9	
	7/19	Chat	Planning activity	7	New member B
	9/27	Chat	Planning activity	8	
	10/19	Research	Walking support by smartphone	8	
	11/23	Research	Walking support by smartphone	5	
	11/29	Research	Walking support by smartphone	6	
2015	2/20	Exchange	I-CCM TV Show	6	New member C,D,E
	3/7	Discussion	Exchange information	5	
	3/24	Discussion	Exchange information	11	
	4/18	Lesson	Tsukishima a Town Walking	11	
	4/25	Project	Alley Map	7	
	5/8	Exchange	Michigan University visited	21	
	5/23	Exchange	California University visited	9	
	5/30	Contest	Interview and visit	15	
	7/11	Contest	Award ceremony	9	
	7/19	Exchange	Liaison Council visited	25	
	8/1	Event	Sumiyoshi Shrine festival	13	
2016	9/19	Chat	NHK program	7	New member C,D,E
	10/11	Exchange	Utah University	8	
	11/15	Project	Alley Map	17	
	12/19	Discussion	Conference	9	
	1/23	Lesson	Okawabata River City	8	
	2/20	Chat	Planning activity	5	
	3/26	Chat	Planning activity	6	
	4/16	Exchange	Ibaraki University visited	13	
	4/23	Project	Guide Boook	8	
	4/23	English class	Started English Class	4	
	5/3	Exchange	Waseda University visited	19	
2017	5/21	Lesson	Students walked in Tsukishima	8	New member C,D,E
	5/28	Project	Guide Boook	10	
	6/9	English class	Read Website	8	
	6/25	Project	Guide Boook	6	
	7/14	English class	Read Website	5	
	7/30	Project	Guide Boook	9	
	8/21	Exchange	Tokyo Metropolitan visited	17	
	8/29	Exchange	Washington University visited	13	
	9/17	Project	Guide Boook	5	
	10/13	English class	Read Guide Boook	5	
	10/29	Project	Guide Boook	8	
	11/26	Project	Guide Boook	10	
	12/17	Project	Guide Boook	9	

Figure.2 Activities for three years of Nagaya School



Figure.3 Main achievements of Tsukishima Nagaya School

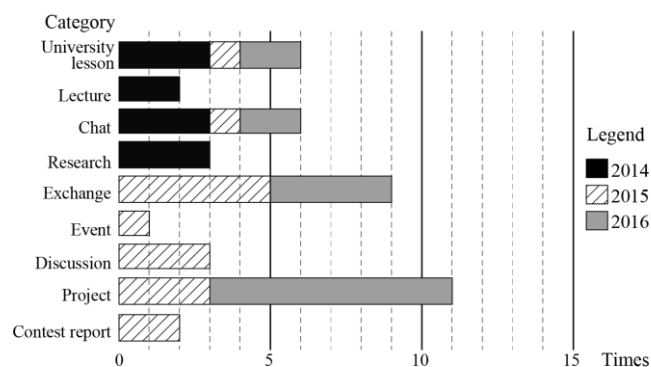

Figure.4 Category of activities in Nagaya School

\*1,2,3 芝浦工業大学大学院理工学研究科建設工学専攻 修士課程

\*4 芝浦工業大学工学部建築学科 教授・博士（工学）

\*1,2,3 Graduate School, Shibaura Institute of Technology

\*4 ProfDepart .of Architecture, Shibaura Institute of Technology